

## METAL SAFETY QUICK COUPLINGS - CSM 08

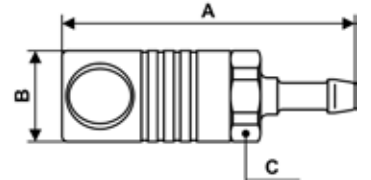

### Hose tail coupler

Profile : ISO 6150C



<b>Min / Max operating pressure</b>	<b>Flow rate at 6 bar</b>	<b>ID passage</b>	<b>Min. / Max temperature</b>
2 / 16 bar	2120 l/min	8 mm	-15 / 70 °C

Part number	For hose ID	Dim. A (mm)	Dim. B (mm)	Dim. C (mm)
CSM 081808	8 mm	87	27	25
CSM 081810	10 mm	87	27	25
CSM 081813	13 mm	92	27	25
CSM 081816	16 mm	92	27	25